



Magnum

High Capacity Reservoir (HCR)

To register your product and activate your guarantee/warranty please visit www.scottoiler.com/guarantee

Note: Check www.scottoiler.com or with your dealer for your bike's compatibility with this kit.



Technical Support



www.scottoiler.com technical@scottoiler.com +44(0)141 955 1100

1. Remove number plate

Remove number plate from bike.

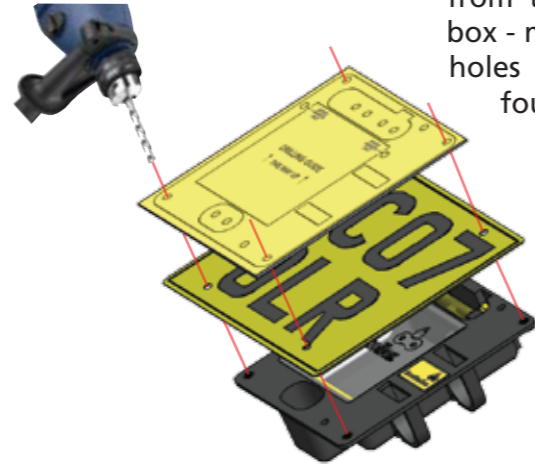

Using drilling template - from the underside of the box - mark & drill four 6mm holes to line up with the four corners of the HCR.

2. Mount the HCR

Centre the HCR on the rear mudguard and attach with three M6 bolts (part 2).

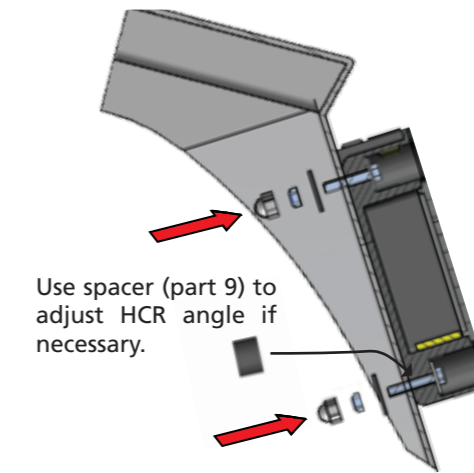
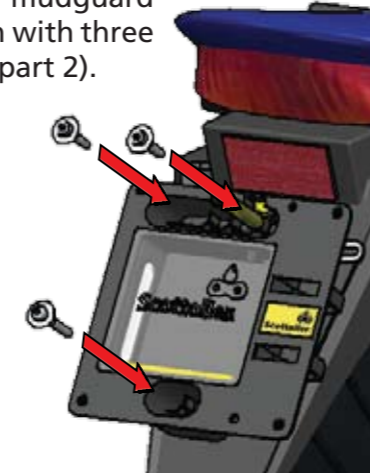

Use 25mm washers (part 5) on the mudguard side and 20mm washers (part 4) at the bolt heads. The spacer (part 9) and 40mm bolt (part 3) can be used on the bottom mount to angle the HCR if required.

Trim the bolts, if necessary, to avoid contact with tyre, then grease and cover with protectors (part 8).

3. Fill HCR

Place the vSystem or eSystem primary reservoir into the HCR.



Fill HCR by swinging out the filler tube and removing the black plug.

Connect the Scottoil bottle, squeeze & hold for 10 secs then release. Repeat until HCR is full.

Fill the primary reservoir by removing the filler plug and filling using the oil bottle and spout.

① Fill HCR

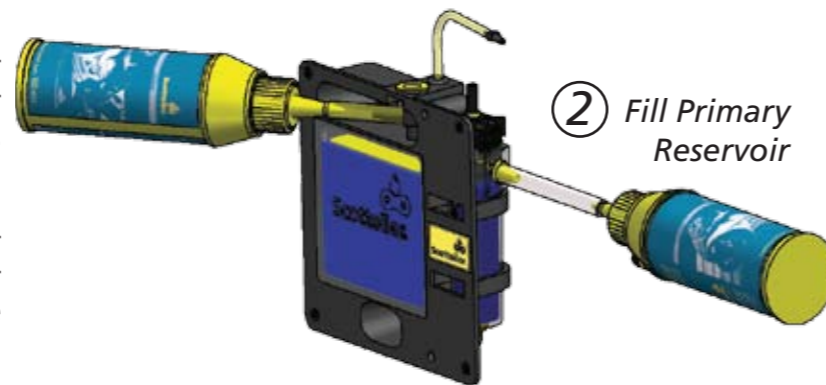

② Fill Primary Reservoir

4. HCR connections



Connect the yellow siphon tubing to the filler plug luer. Insert filler plug into the primary reservoir.

vSystem

Route clear dispenser tubing (part 10) to outlet nozzle and connect. Connectors (part 7) can be used to join existing tubing.

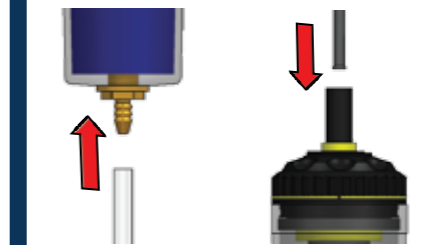

Route black vacuum tubing (part 11) to RMV top and connect.

Hint: Refer to vSystem or eSystem instructions for detailed guidance on the routing & connecting of tubing.

eSystem

Route clear dispenser tubing (part 10) to outlet nozzle and connect. Connectors (part 7) can be used to join existing tubing. Connect REP to eSystem wiring loom.

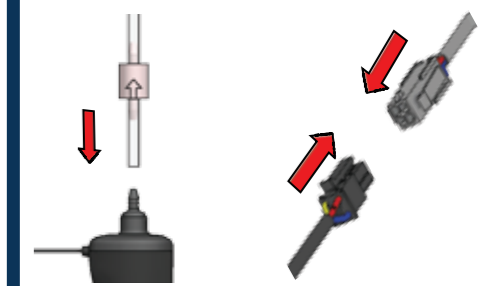

5. Prime the system Only prime the system if the delivery tubing is empty of oil

vSystem

Remove yellow siphon tubing from filler plug. Turn RMV adjuster knob to the 'Prime' setting.

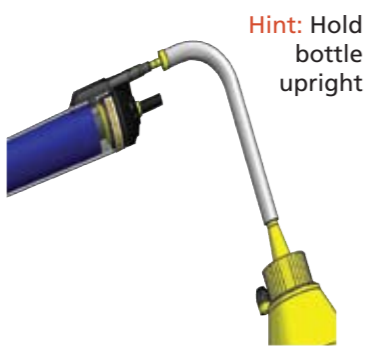

Connect spout to the filler plug and squeeze bottle to force oil down the delivery line using air pressure.

Hint: Hold bottle upright

eSystem

Navigate to the 'Prime' menu on the eSystem display unit. Press 'set' to run a prime cycle for 60 seconds. Repeat this step until oil starts to drip from the dispenser nozzle.



Note: Please refer to the eSystem instructions for full details on how to prime system.

6. Adjust flowrate

vSystem

Reconnect the yellow siphon tubing to the filler plug. Start your bike and allow the engine to warm up. Adjust flow to give approximately 1 drop per minute. Check chain condition after a short journey and adjust as necessary.



Hint: More than 2 drops per minute will result in excess fling

60 secs

eSystem

On the eSystem display unit, navigate to the 'Driving Screen'. Use the 'set' button to cycle through the desired flow rates until 60 - 70 seconds per drop (s/dp) is shown. Check chain condition after a short journey and adjust as necessary.



7. Number plate

Line up the number plate with the four corner holes of the HCR. Attach using the four M5 screws (part 13).



